

Finishes interface detail

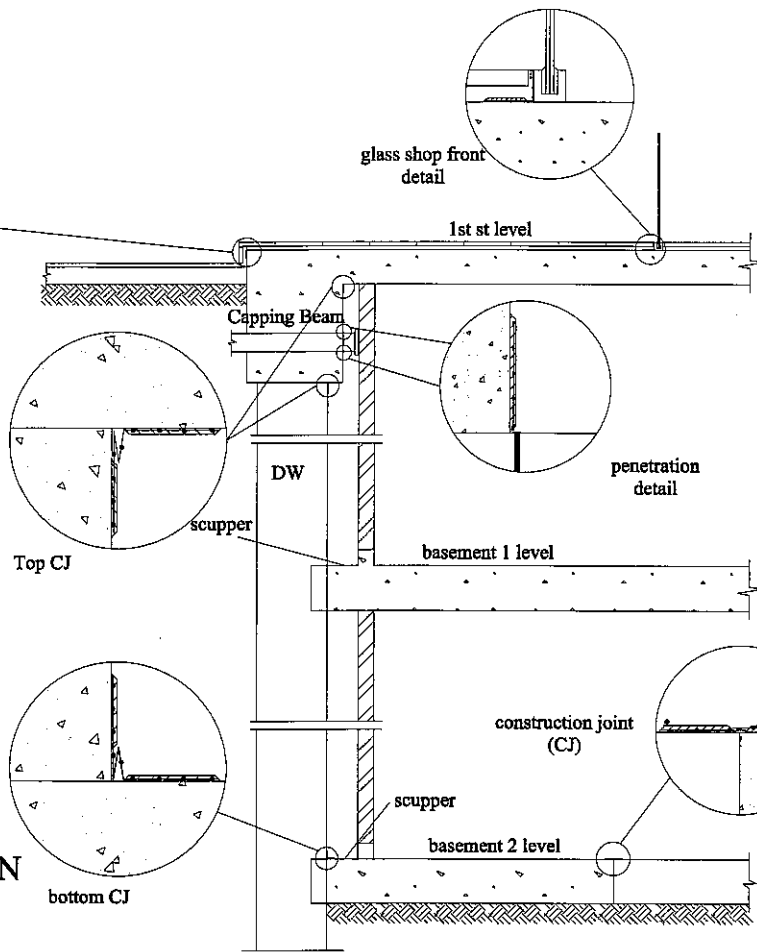

**SPECIFICATION BASEMENT DETAIL**  
(Diaphragm Wall)

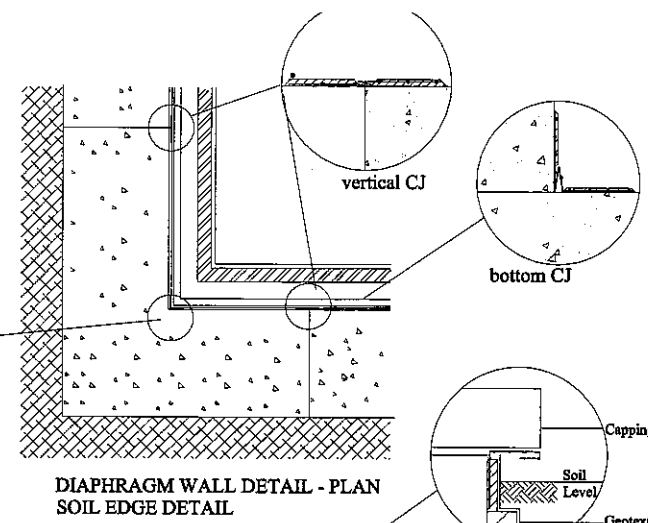

**DIAPHRAGM WALL DETAIL - PLAN SOIL EDGE DETAIL**

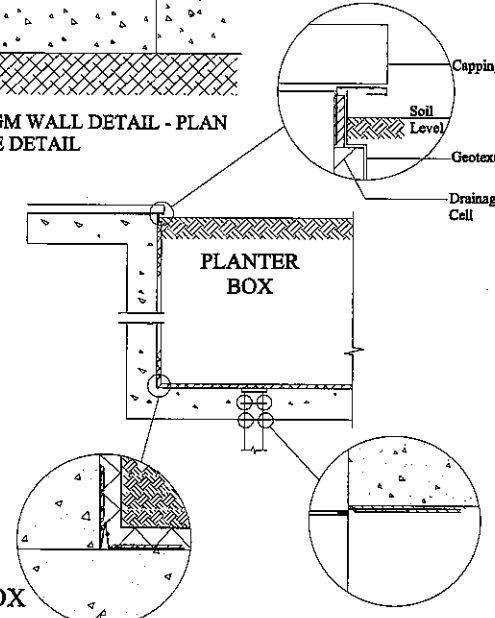

**PLANTER BOX DETAIL**

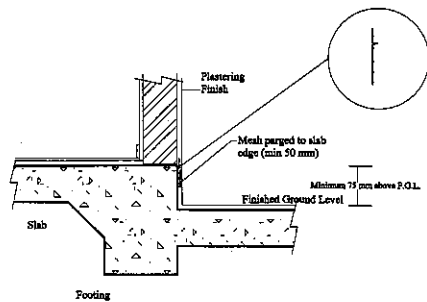

**SLAB PERIMETER INSTALLATION SUSPENDED SLAB DETAIL**

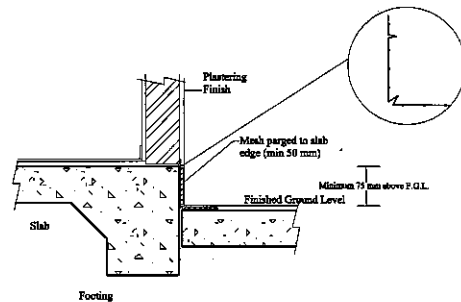

**SLAB PERIMETER INSTALLATION NON-SUSPENDED SLAB DETAIL**

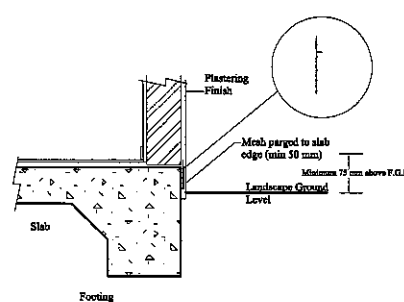

**SLAB PERIMETER INSTALLATION SOIL EDGE DETAIL**

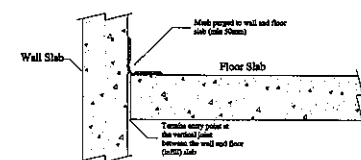

**PERIMETER JUNCTION**

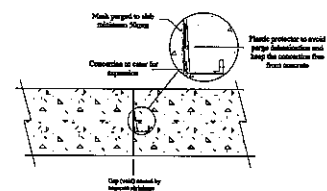

**PRE-POUR CJ**

**NOTES:**  
This document is intended only for the use of the individual or entity to which it is addressed to and may contain information that is privileged, confidential, and exempt from disclosure under applicable law. If you are not intended recipient, you are hereby notified that any use, dissemination, or copying of this document is strictly prohibited. If you have received this document in error, please notify us immediately by telephone, and return the original document to us at the above address at sender's cost. Thank you.

The TERMI-MESH System is designed to stop subterranean termite from entering a building by blocking any foundation entry points including construction and control joints, cavity walls below final ground level, retaining walls, atrium pipe penetrations through slabs, blockouts in concrete, brick/block pipes. The System consists of a stainless steel mesh, stainless steel clamps and TERMI-PARGE (a specialized bonding cement).

SPECIALIST SUB- CONTRACTOR

TERMI-MESH Singapore Pte Ltd  
11, JALAN PUNJUNG 117 AN SOILING 61-10  
SINGAPORE 610117  
TEL: 6252514 FAX: 6252514



**DRAWING TITLE:**  
**TERMI-MESH INSTALLATION DETAILS**

COORDINATED			
ARCHD	MECH	ELEC.	CIVIL
JOB NO.	DATE	SCALE	NTSS
DRAWN	CHECKED	DATE	REV.
DRAWING NO. TERMI/dw08-002/dw			REV. 0

**TERMI-MESH INSTALLATION DETAILS**